



**NeoDrys®
(Saliva Absorbent)
Instructions for Use**

#53161- NeoDrys ORIGINAL- Small

#53162- NeoDrys ORIGINAL- Large

#53163- NeoDrys REFLECTIVE- Small

#53164- NeoDrys REFLECTIVE- Large



CAUTION:

Rx Only. These instructions, in whole or in part, are not a substitute for formal training. Appropriate professional education is REQUIRED prior to using this device clinically. NeoDry saliva absorbents are intended to be used by qualified dental practitioners in dental clinics, hospitals, labs, or schools for dental applications.

DESCRIPTION:

The NeoDry products are manufactured in two sizes, Large and Small. The NeoDrys are manufactured with two backing types, Reflective, a metalized film backing, and Original, a white backing. The NeoDrys are used to absorb saliva from the parotid gland. They have a semi-permeable barrier to capture the saliva with super absorbent particles and trap the saliva within the body of the NeoDrys. Within the NeoDrys is a core stiffener to offer cheek retraction as the product expands with saliva.

INDICATIONS

NeoDrys are indicated for anyone requiring dental care. NeoDrys are intended to absorb moisture from the parotid gland for up to 15 minutes. The super absorbent polymer traps moisture as a gel when in contact with saliva. The NeoDrys core stiffener provides cheek retraction to facilitate procedures far back in the oral cavity. The NeoDrys backings brighten the oral cavity during procedures and the medical grade poly netting adhere gently to the tissue to stay in place yet removes easily with water spray.

CONTRAINDICATIONS TO USE

Use of Microcopy NeoDrys is contraindicated on any patient who is allergic to any of the components of the product.

CLINICAL PRECAUTIONS AND WARNINGS:

- Microcopy NeoDrys are for single-patient-use only.
- Do **NOT** use the product if package is opened or damaged. Discard any damaged NeoDrys immediately.
- Do **NOT** use if the product is damaged.
- To remove without tissue irritation, release adhesion with ample water spray to the buccal side of the NeoDrys.
- Non-toxic by ingestion. If product bursts, remove as much as possible from mouth. Rinse mouth thoroughly with plenty of water. If adverse symptoms appear, seek medical attention.
- Always keep track of Lot Numbers of NeoDrys to ensure traceability.

Failure to follow the instructions for use may lead to the following: allergic reaction, product leakage, procedural delay, minor irritation and discomfort, and cross-contamination.

STORAGE

- Microcopy NeoDrys should be stored in a dry, closed container.
- Improper storage conditions will shorten the shelf life and may cause malfunction of the product.

DISPOSAL

- Each used saliva absorbent must be disposed in a biohazards waste container.
- Each unused saliva absorbent may be disposed in a regular waste container.

PRODUCT SHELF LIFE

- Product shelf life is four (4) years unless product is damaged.



Spaulding's Classifications

maxill inc.

Canadian Head Office
80 Elm Street
St. Thomas, ON N5R 6C8
Toll Free: 1-800-268-8633
Phone: 1-519-631-7370
Fax: 519-631-3388

USA Head Office
500 West Main Street
Cortland, OH 44410
Toll Free: 1-855-462-9455
Phone: 1-330-637-1176
Fax: 1-330-637-1154

microcopy
NeoDrys®
 (Saliva Absorbent)
 Instructions for Use

- #53161- NeoDrys ORIGINAL- Small
- #53162- NeoDrys ORIGINAL- Large
- #53163- NeoDrys REFLECTIVE- Small
- #53164- NeoDrys REFLECTIVE- Large



CLINICAL USE:

Select the NeoDrys size which adequately covers the buccal mucosa.

Step #1

- Insert the NeoDrys as shown with the color side against the cheek.

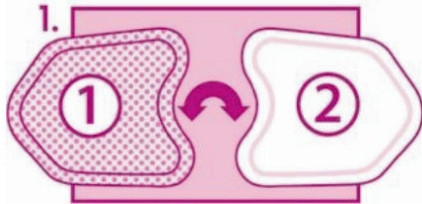

Step #2

- Point the NeoDrys to the back of the mouth as shown. In a few seconds, the NeoDrys will begin to adhere to the tissue and stay in place.



Step #3

- NeoDrys are used to absorb moisture from the parotid gland for up to 15 minutes.

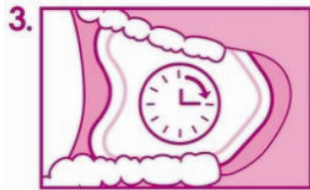

Step #4

- **Important:** To remove without irritating tissue, release adhesion with ample water spray to the buccal side of the NeoDrys.



Spaulding's Classifications

maxill inc.

Canadian Head Office
 80 Elm Street
 St. Thomas, ON N5R 6C8
 Toll Free: 1-800-268-8633
 Phone: 1-519-631-7370
 Fax: 519-631-3388

USA Head Office
 500 West Main Street
 Cortland, OH 44410
 Toll Free: 1-855-462-9455
 Phone: 1-330-637-1176
 Fax: 1-330-637-1154